

**Item D1 Appendix 1 Application Plans
Creation of two new sections of road as dedicated Bus Rapid
Transit route for buses, cyclists and pedestrians only - Land to the
north of Dover and to the south of Whitfield, Kent – DOV/20/01048
(KCC/DO/0178/2020)**

Definitive Map of Public Rights of Way

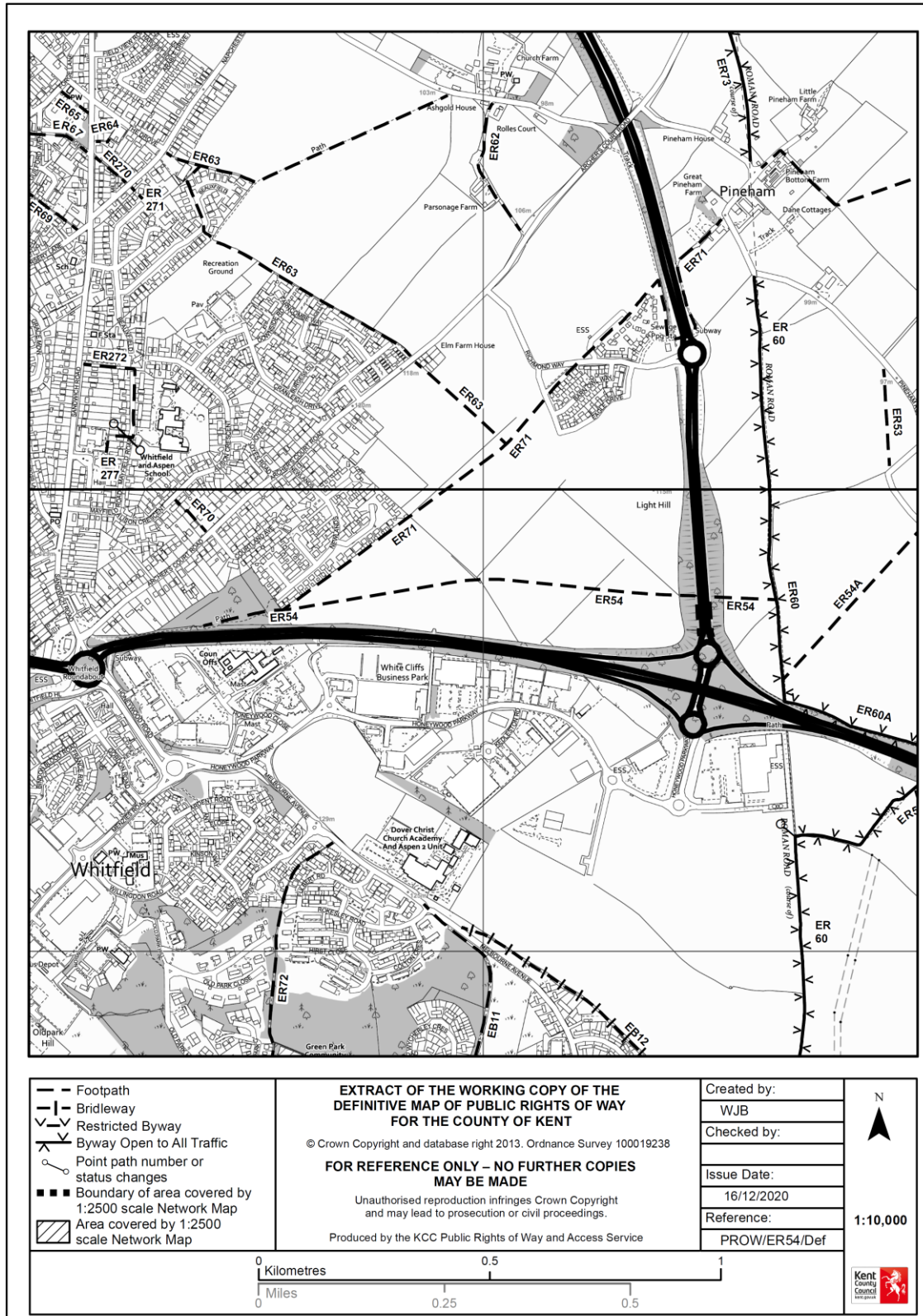

Item D1 Appendix 1 Application Plans

Creation of two new sections of road as dedicated Bus Rapid Transit route for buses, cyclists and pedestrians only - Land to the north of Dover and to the south of Whitfield, Kent – DOV/20/01048 (KCC/DO/0178/2020)

Red Line Boundary Section 1

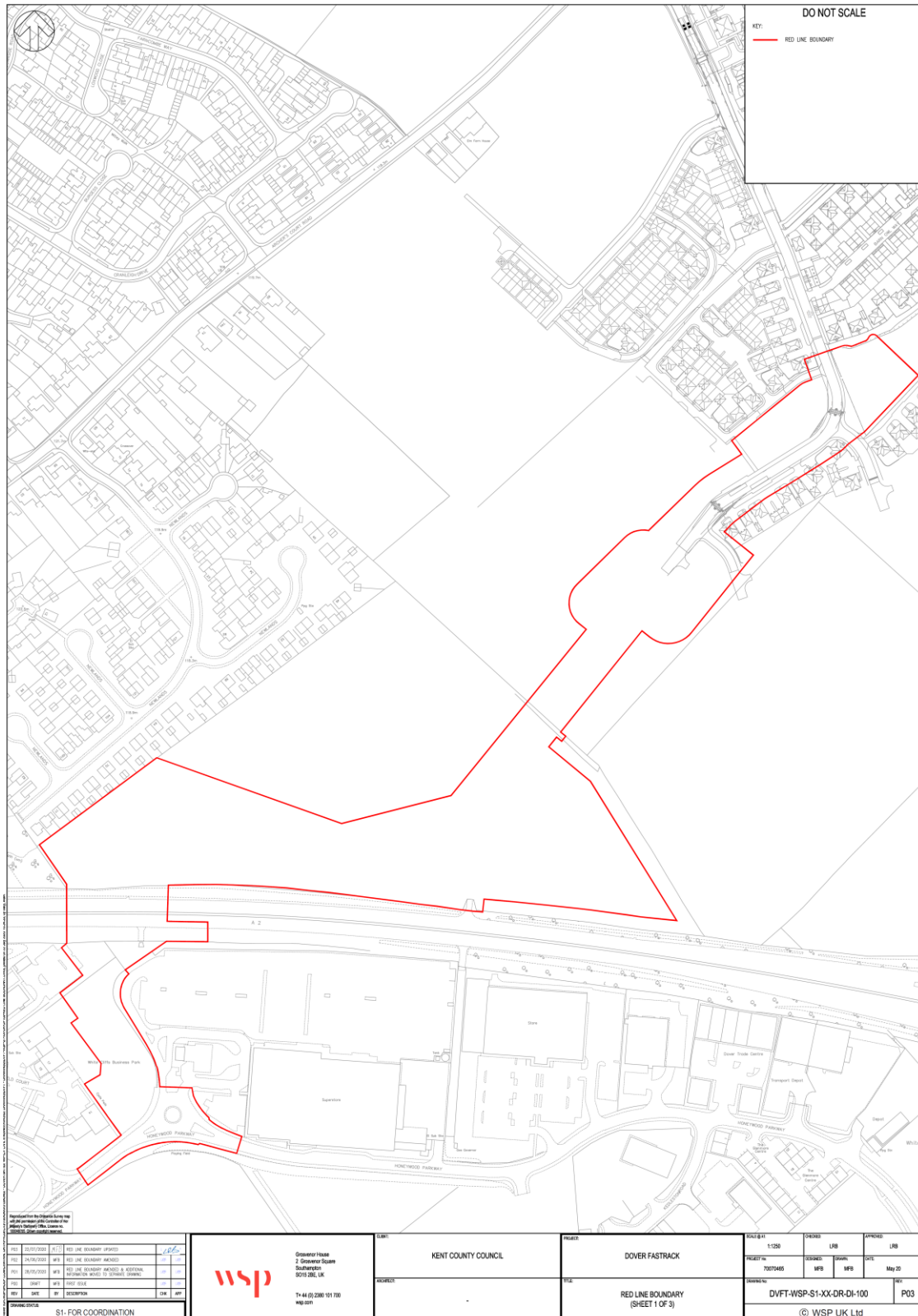

Item D1 Appendix 1 Application Plans

Creation of two new sections of road as dedicated Bus Rapid Transit route for buses, cyclists and pedestrians only - Land to the north of Dover and to the south of Whitfield, Kent – DOV/20/01048 (KCC/DO/0178/2020)

Section 1 – General Arrangement (plan 1 of 2)



Item D1 Appendix 1 Application Plans

Creation of two new sections of road as dedicated Bus Rapid Transit route for buses, cyclists and pedestrians only - Land to the north of Dover and to the south of Whitfield, Kent – DOV/20/01048 (KCC/DO/0178/2020)

Section 1 – General Arrangement (plan 2 of 2)

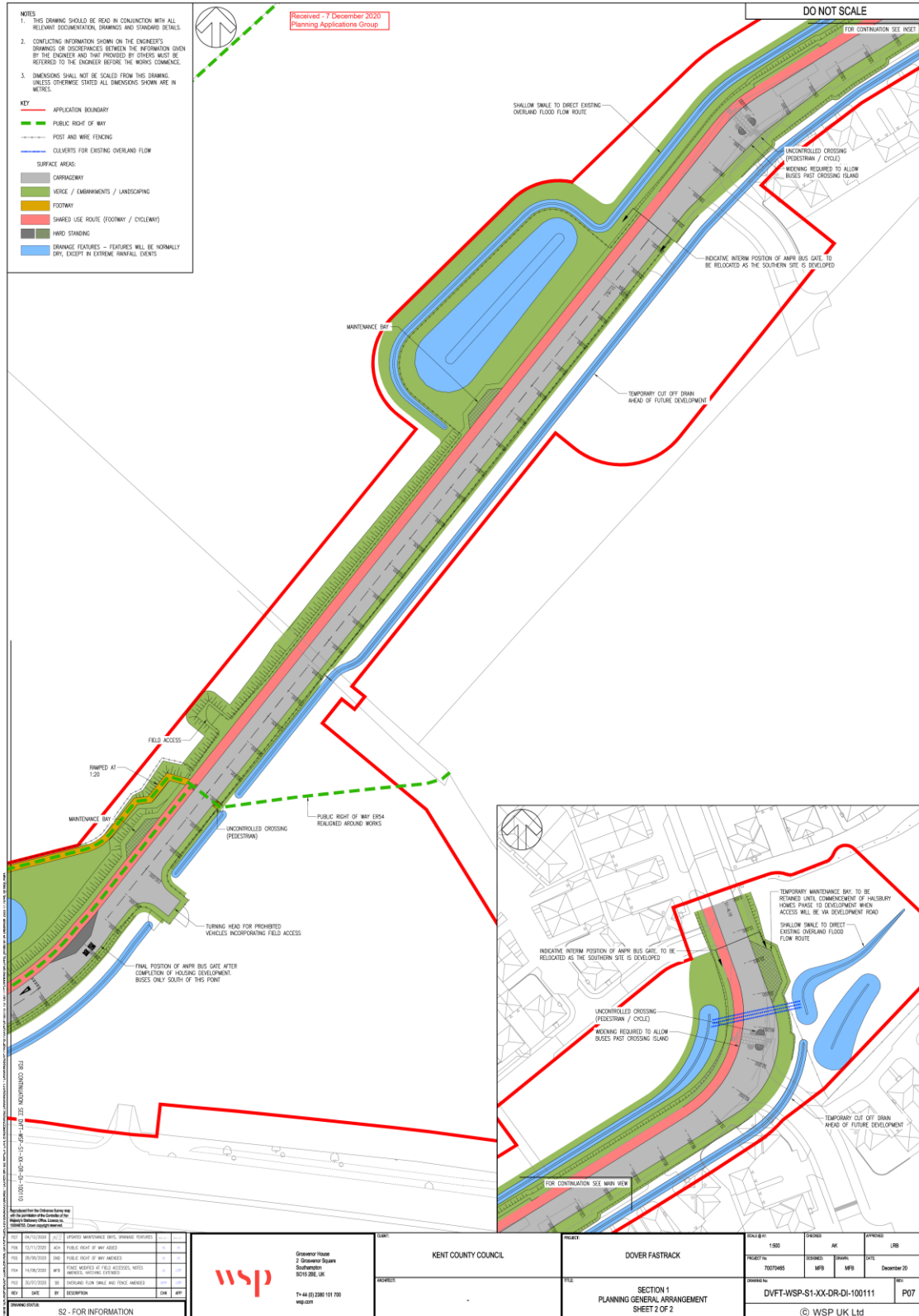

Item D1 Appendix 1 Application Plans

Creation of two new sections of road as dedicated Bus Rapid Transit route for buses, cyclists and pedestrians only - Land to the north of Dover and to the south of Whitfield, Kent – DOV/20/01048 (KCC/DO/0178/2020)

Section 1 - Cross Sections

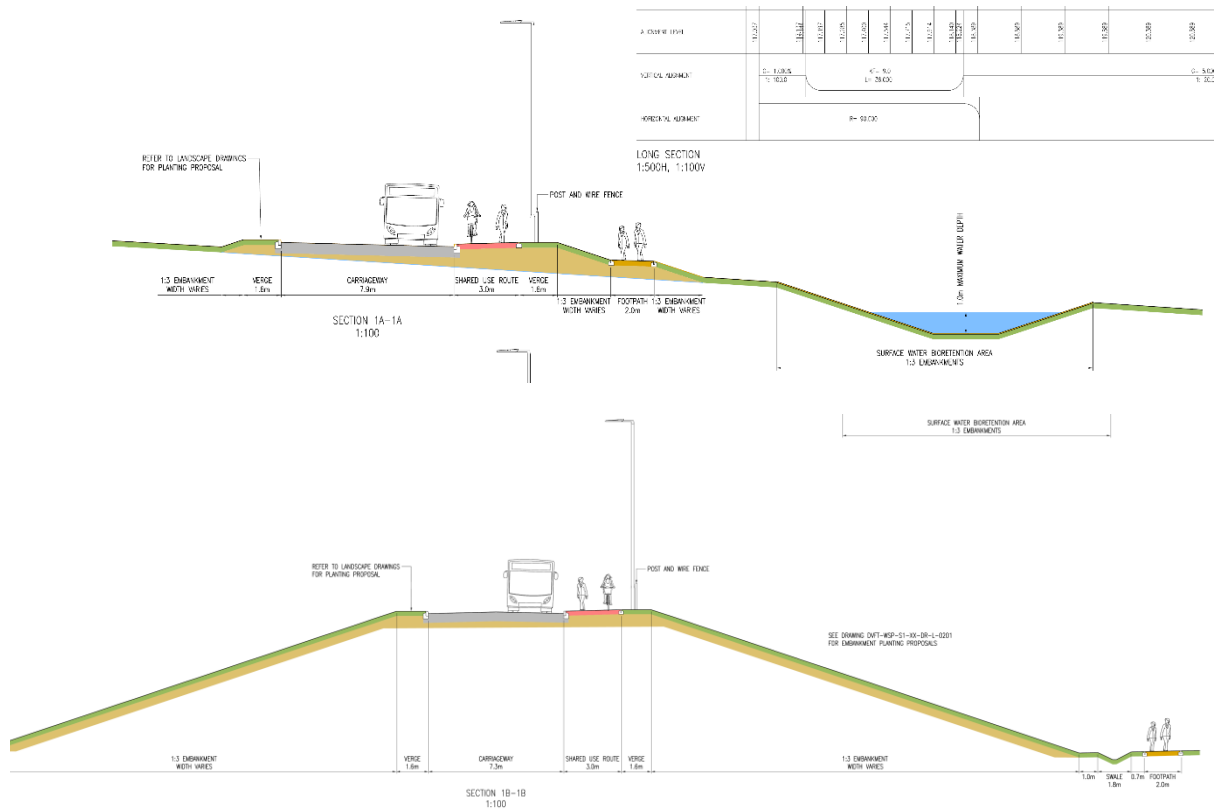
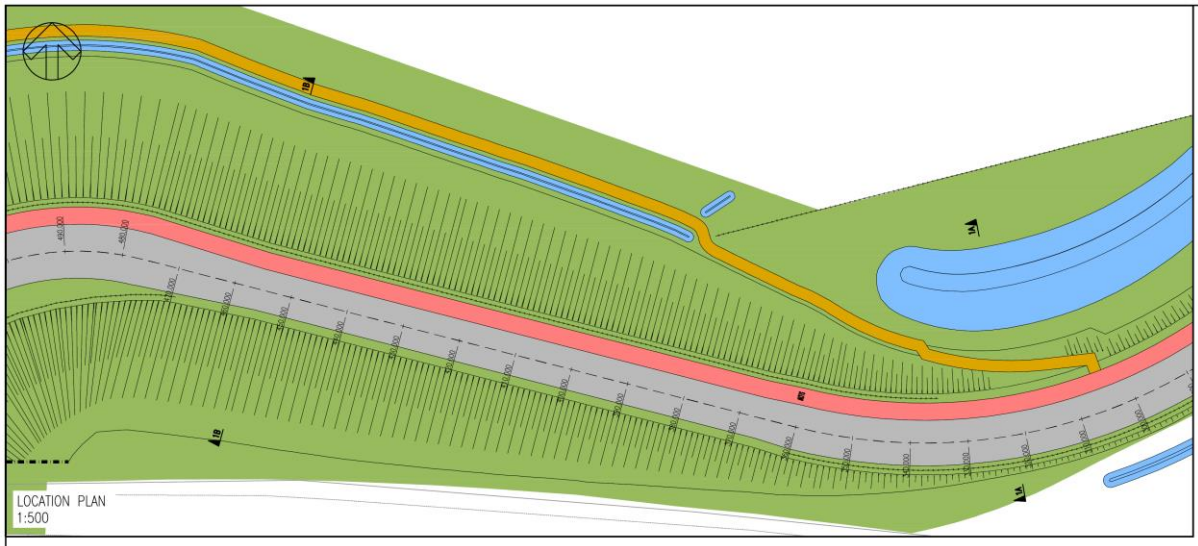

**Item D1 Appendix 1 Application Plans
Creation of two new sections of road as dedicated Bus Rapid
Transit route for buses, cyclists and pedestrians only - Land to the
north of Dover and to the south of Whitfield, Kent – DOV/20/01048
(KCC/DO/0178/2020)**

Section 1 – Bridge Cross Section

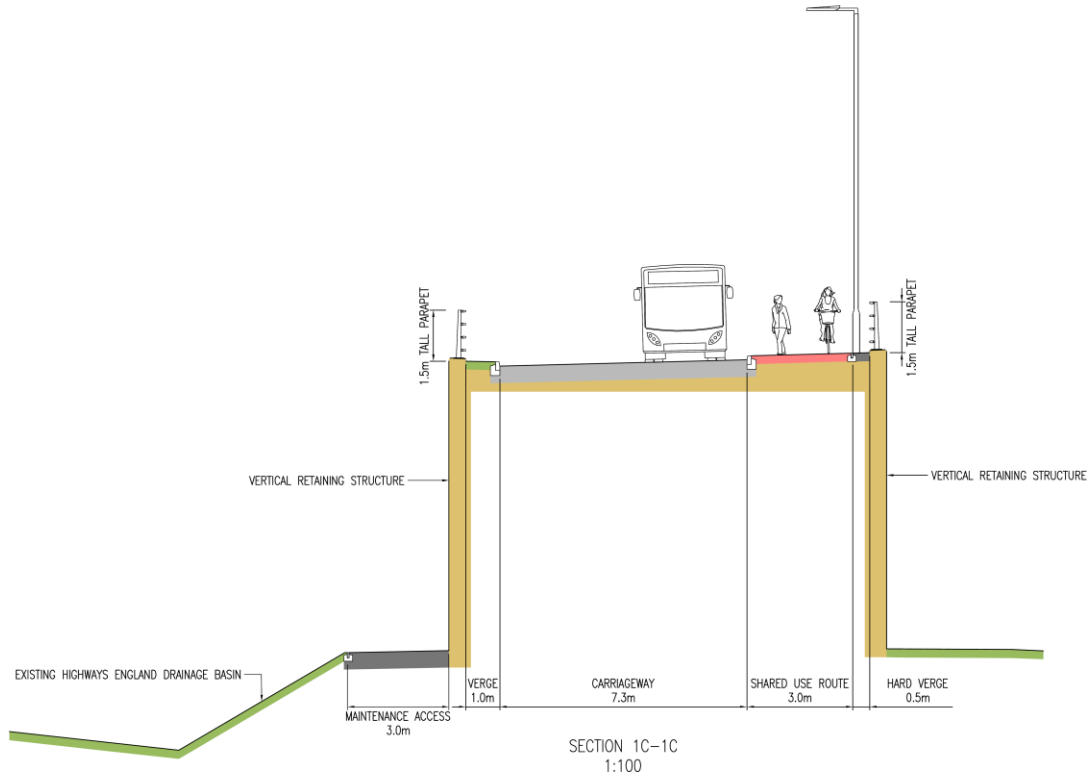
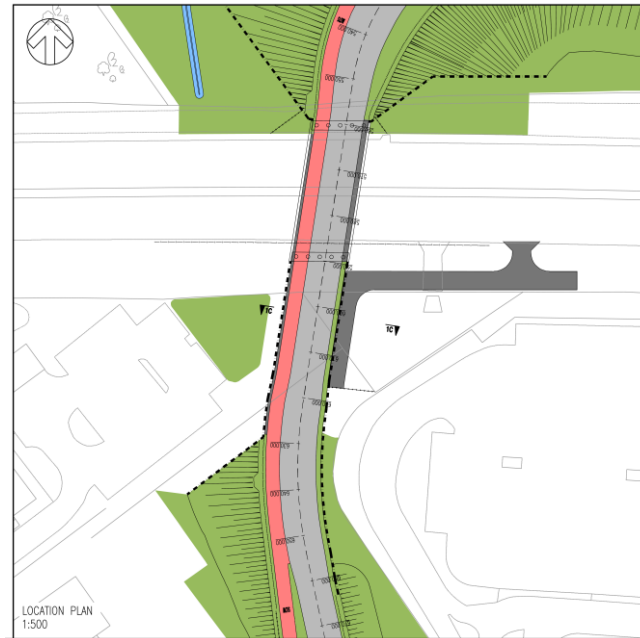

Item D1 Appendix 1 Application Plans

Creation of two new sections of road as dedicated Bus Rapid Transit route for buses, cyclists and pedestrians only - Land to the north of Dover and to the south of Whitfield, Kent - DOV/20/01048 (KCC/DO/0178/2020)

Bridge General Arrangement Drawing

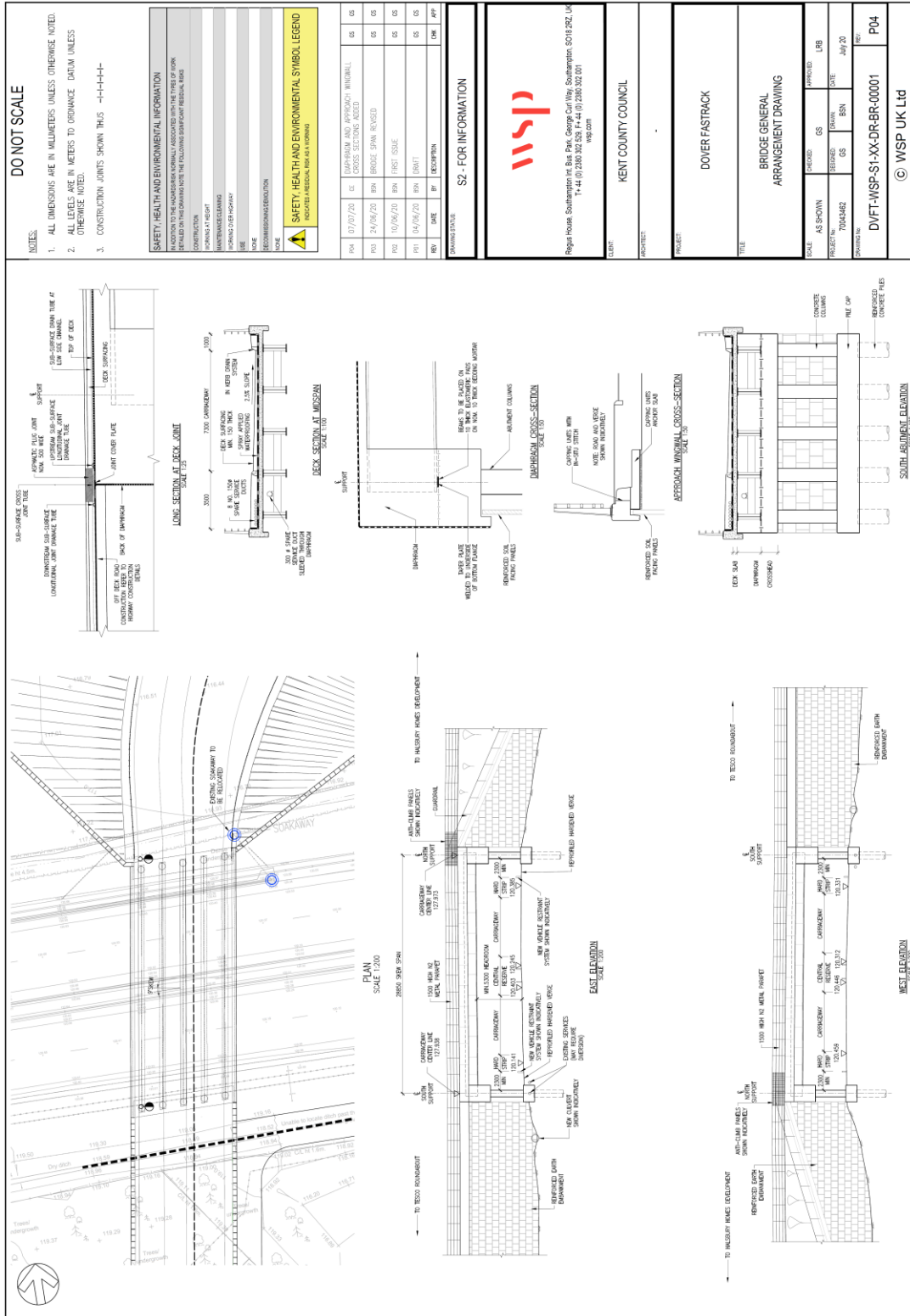

**Item D1 Appendix 1 Application Plans
Creation of two new sections of road as dedicated Bus Rapid
Transit route for buses, cyclists and pedestrians only - Land to the
north of Dover and to the south of Whitfield, Kent – DOV/20/01048
(KCC/DO/0178/2020)**

Typical Bus Gate Elevation

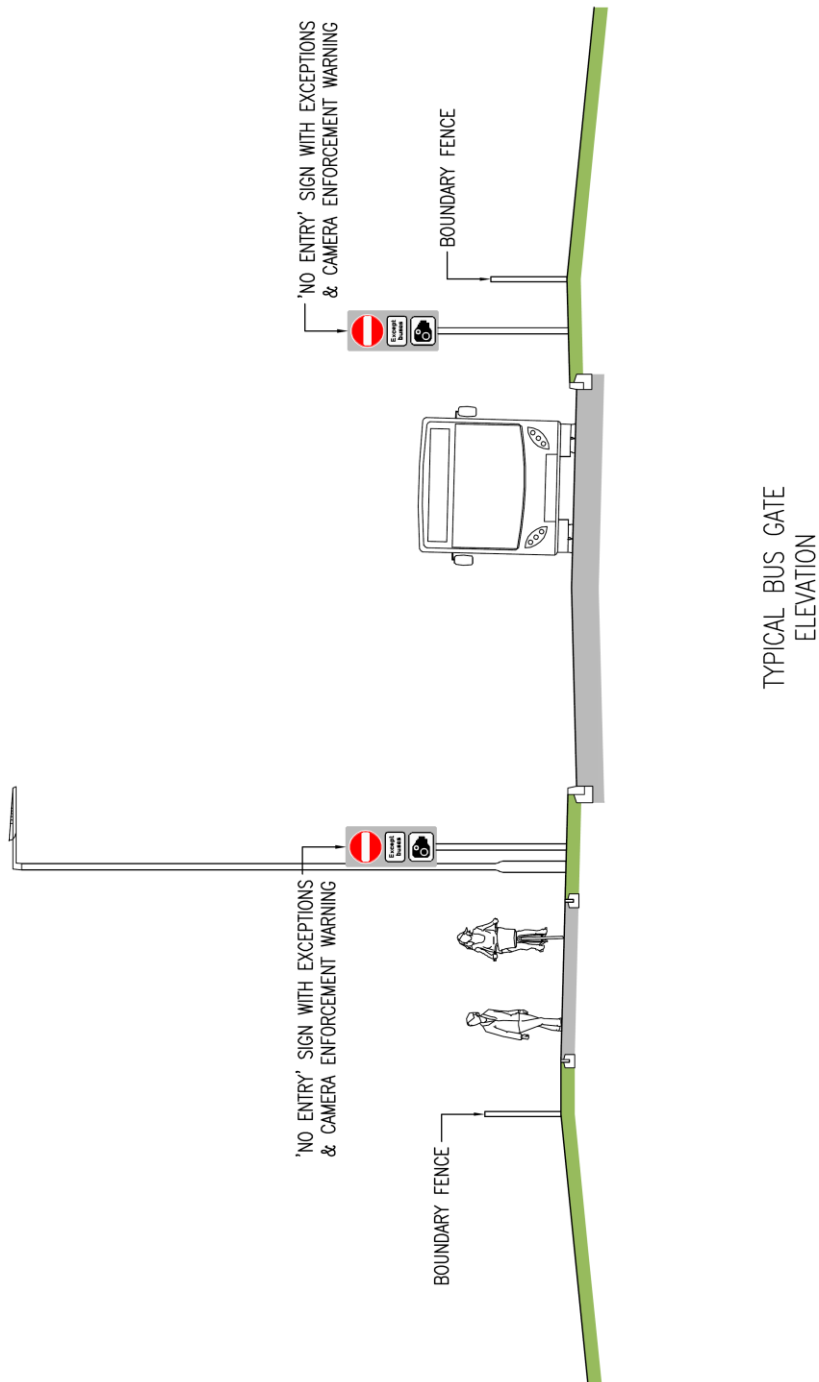

**Item D1 Appendix 1 Application Plans
Creation of two new sections of road as dedicated Bus Rapid
Transit route for buses, cyclists and pedestrians only - Land to the
north of Dover and to the south of Whitfield, Kent – DOV/20/01048
(KCC/DO/0178/2020)**

Red Line Boundary Section 2 (plan 1 of 2)

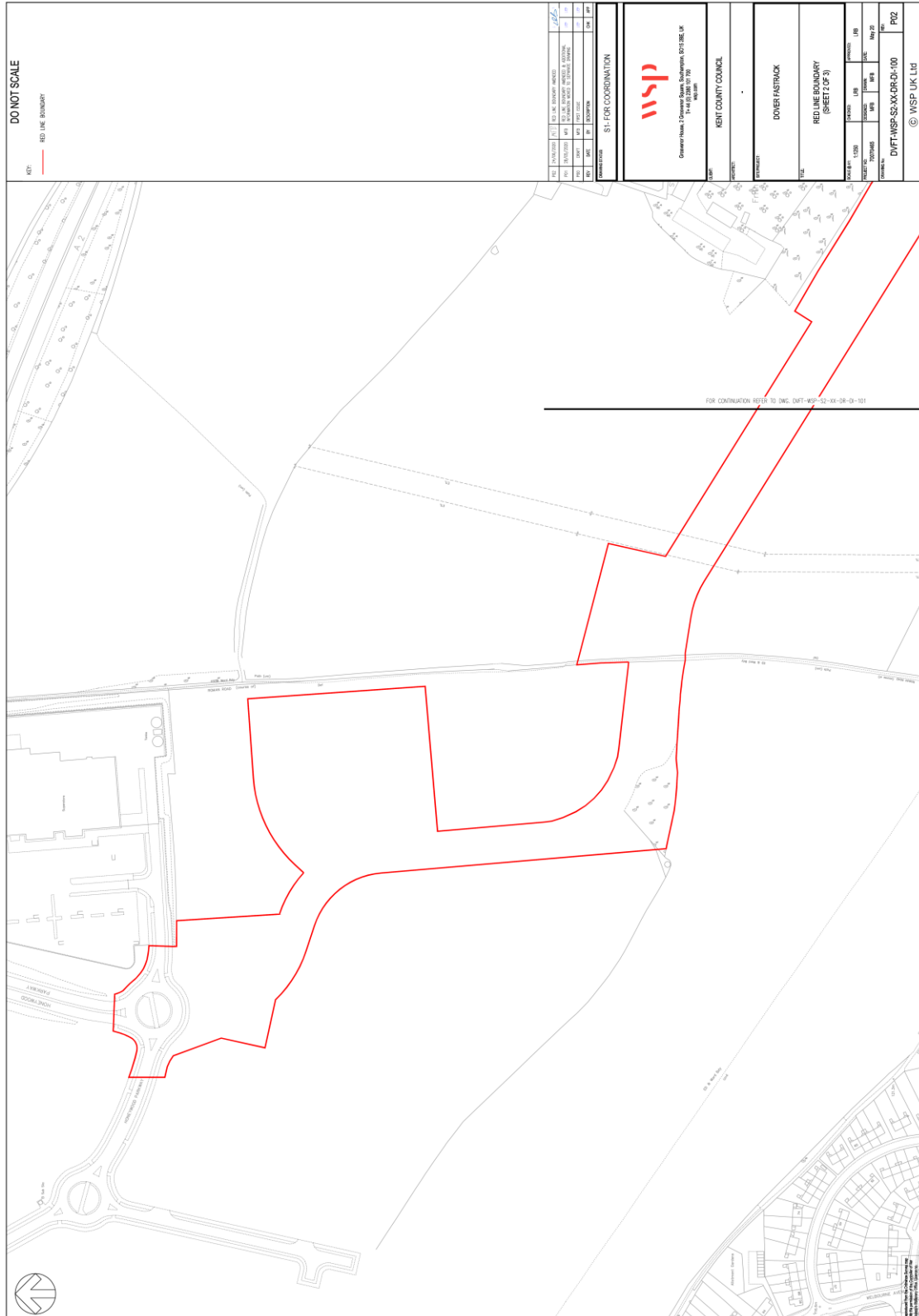

Item D1 Appendix 1 Application Plans

Creation of two new sections of road as dedicated Bus Rapid Transit route for buses, cyclists and pedestrians only - Land to the north of Dover and to the south of Whitfield, Kent – DOV/20/01048 (KCC/DO/0178/2020)

Red Line Boundary Section 2 (plan 2 of 2)

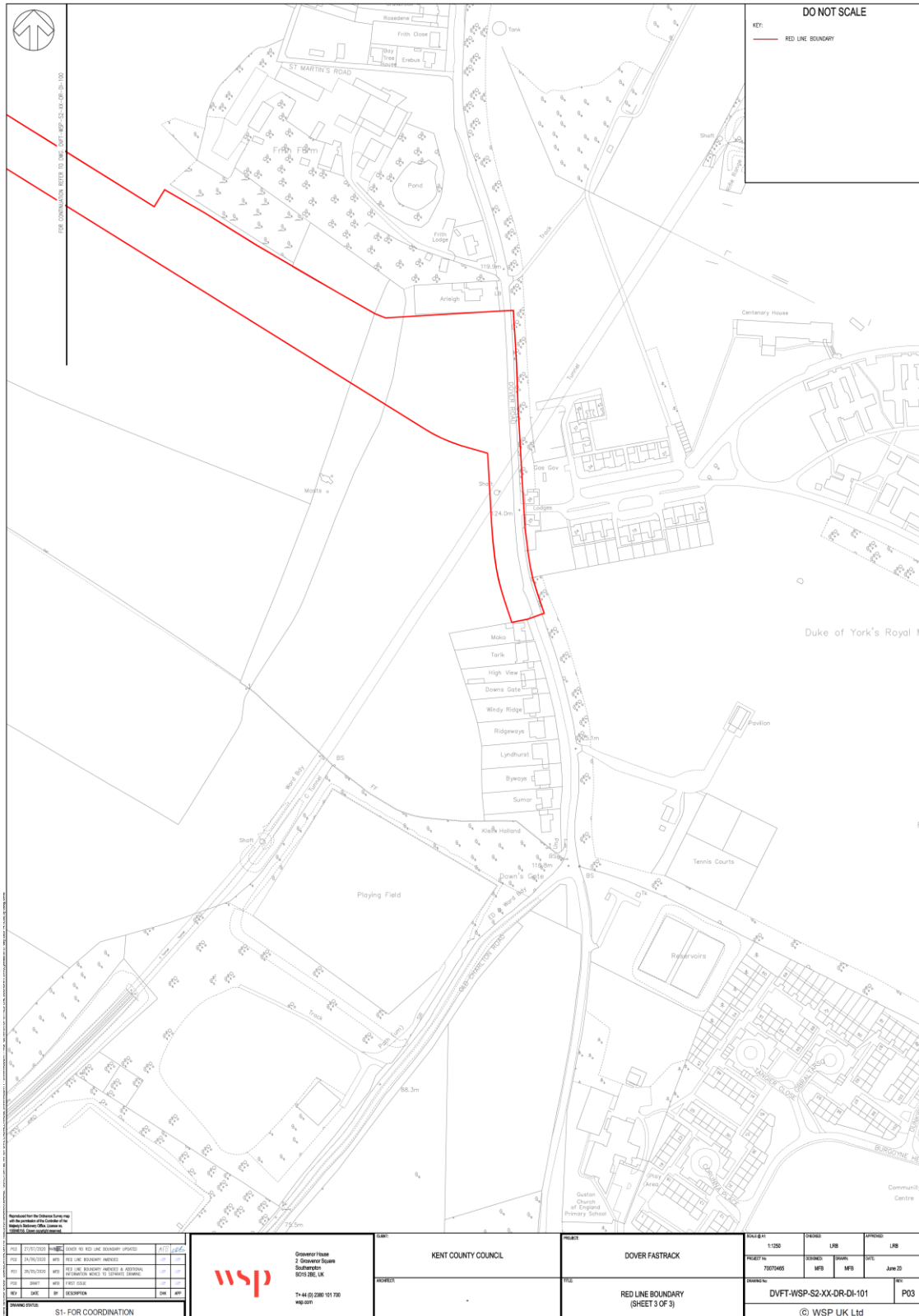

NO	DATE	BY	DESCRIPTION	STATUS
001	20/07/2020	WSP	ISSUED FOR RED LINE BOUNDARY STUDY	FOR INFO
002	24/07/2020	WSP	RED LINE BOUNDARY MARKED	FOR INFO
003	26/07/2020	WSP	SET UP BOUNDARY MARKS & POSITION MARKERS TO MATCH TO SURVEY COORDINATES	FOR INFO
004	28/07/2020	WSP	FIELD VISIT	FOR INFO
005	30/07/2020	WSP	REVISION	FOR INFO

FOR COORDINATION

wsp

Overseas Team
2 Grosvenor Square
Suite 205
W1G 0AE, UK

T: +44 (0) 20 7461 1010
www.wsp.com

CLIENT	KENT COUNTY COUNCIL
PROJECT	DOVER FASTRACK
DESCRIPTION	RED LINE BOUNDARY (SHEET 3 OF 3)

DATE	1:1250	DESIGN	LFB	APPROVED	LFB
PROJECT NO.	7007485	ISSUED	MPS	DATE	June 20
DRAWING NO.	DVFT-WSP-S2-XX-DR-DI-101			P03	
© WSP UK Ltd					

Item D1 Appendix 1 Application Plans

Creation of two new sections of road as dedicated Bus Rapid Transit route for buses, cyclists and pedestrians only - Land to the north of Dover and to the south of Whitfield, Kent – DOV/20/01048 (KCC/DO/0178/2020)

Section 2 - General Arrangement (plans 1 and 2 of 4)



Item D1 Appendix 1 Application Plans

Creation of two new sections of road as dedicated Bus Rapid Transit route for buses, cyclists and pedestrians only - Land to the north of Dover and to the south of Whitfield, Kent – DOV/20/01048 (KCC/DO/0178/2020)

Section 2 - General Arrangement (plans 3 and 4 of 4)



Item D1 Appendix 1 Application Plans

Creation of two new sections of road as dedicated Bus Rapid Transit route for buses, cyclists and pedestrians only - Land to the north of Dover and to the south of Whitfield, Kent – DOV/20/01048 (KCC/DO/0178/2020)

Section 2 – Cross Section

